

SPECIFICATION

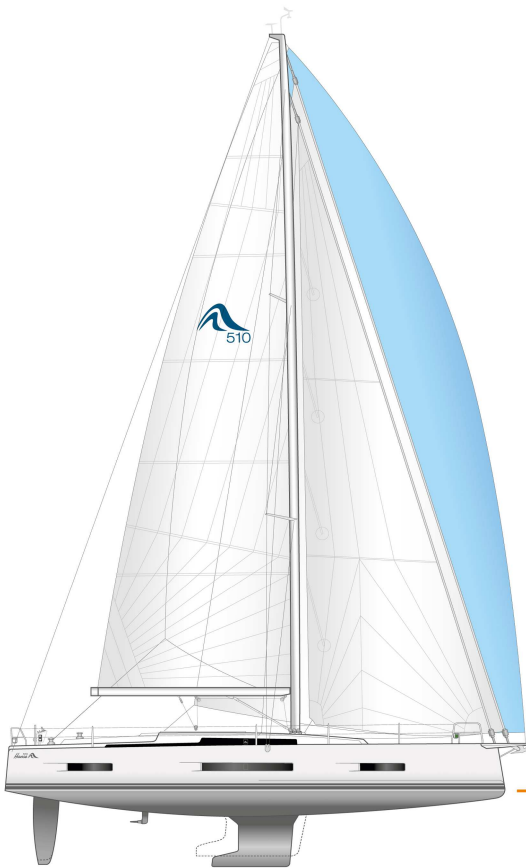

| | | | |
|----------------|------------------------|---------|------------|
| LOA | | 15.97 m | 52' 5" |
| Hull length | | 15.25 m | 50' 0" |
| LWL | | 14.40 m | 47' 3" |
| Beam | | 4.91 m | 16' 1" |
| Draft | | | |
| shallow keel | | 1.98 m | 6' 6" |
| L-keel, medium | | 2.43 m | 7' 12" |
| Displacement | | | |
| L-keel, medium | approx. | 16.54 t | 36,475 lbs |
| Engine Diesel | | | |
| standard | approx. | 80 PS | 80 hp |
| option | approx. | 110 PS | 110 hp |
| Fuel tank | approx. | 200 l | 53 gal |
| Fresh water | approx. | 450 l | 119 gal |
| CE Certificate | A - 12, B - 14, C - 18 | | |
| Design | Berret - Racoupeau | | |
| Interior | Berret - Racoupeau | | |

| | | | |
|----------------------|---------|-----------------------|-------------|
| Mast length above WL | approx. | 23.55 m | 77' 3" |
| Upwind sail area | approx. | 128.00 m ² | 1,377 sq ft |
| Downwind sail area | approx. | 255.00 m ² | 2,744 sq ft |
| Main sail | approx. | 66.00 m ² | 710 sq ft |
| Jib | approx. | 53.00 m ² | 570 sq ft |
| Genoa | approx. | 62.00 m ² | 667 sq ft |
| Reacher | approx. | 94.00 m ² | 1011 sq ft |
| Gennaker | approx. | 189.00 m ² | 2,034 sq ft |

510

All measurements/figures are approximate. Errors and omissions excepted. Specification and material can be changed without notice. Valid from 2022.09.02.

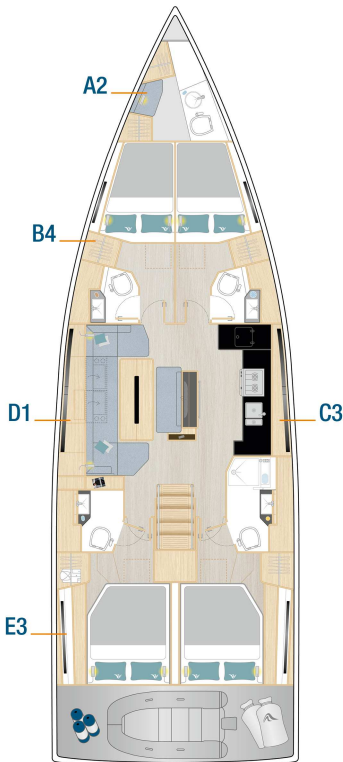
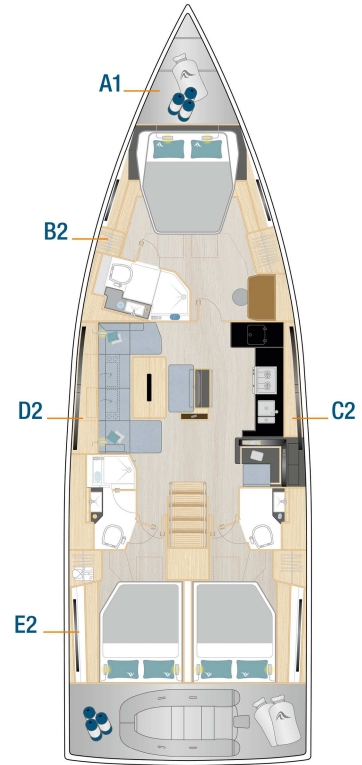
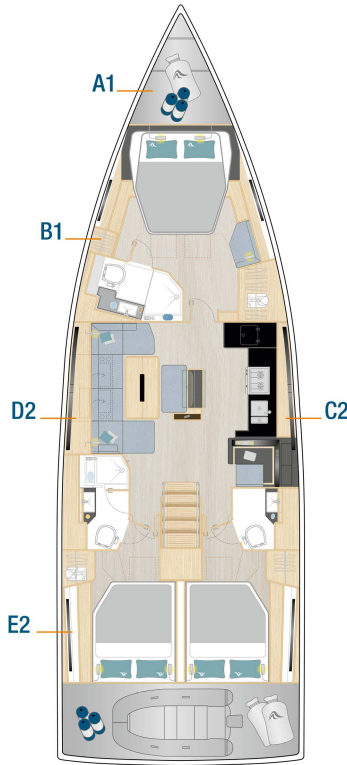
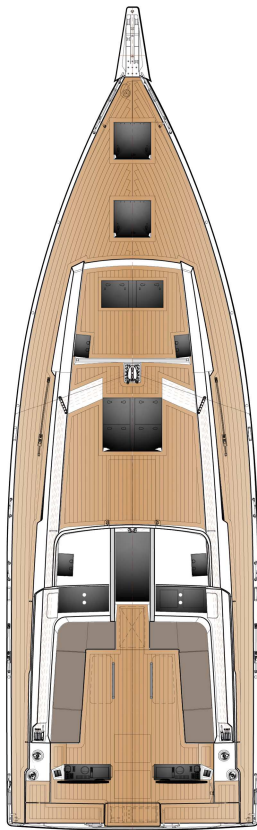

Option

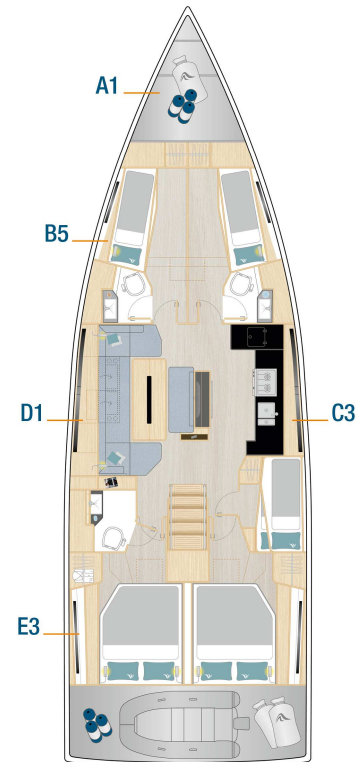
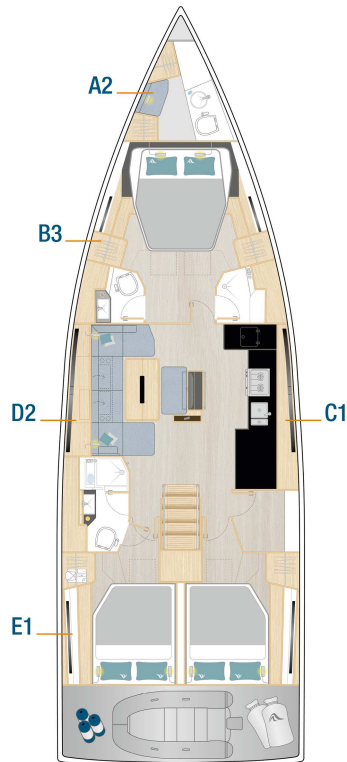

HULL

- 8 hull windows (4 each side)
- GRP hull, isophthalic gelcoat, colour: Signal White (RAL 9003), 1st layer vinyl ester resin and balsa sandwich laminat
- Waterline and cove line, isophthalic gelcoat, colour: Dark Grey (RAL 7043)

KEEL

- L-keel, cast iron, draft: 2.43 m
- GRP rudder with sea-water resistant aluminium shaft and selfaligning bearings

LAYOUT & INTERIOR

- A1: Saillocker
- B1: Enlarged master cabin with island double berth, 2 lockers, seating area and ensuite head with separate shower stall (only with A1 layout)
- C1: Saloon with full functional large L-galley on stb (only with E1 or E2 layout)
- D1: Spacious saloon with large dining area with bar, library and head on port
- E1: 2 aft cabins with double berth, storage space and storage room on stb (only with C1 or C2 layout)
- 3-burner gas stove with oven, waste bin, 12 V fridge approx. 135 l, double stainless steel sink with mixing tab
- Interior furniture in high quality marine plywood, Satin Varnish
- Hanse companionway closing system
- Saloon table, fixed
- Worktop in galley and heads - Black Quartz

WOOD (FURNITURE, FLOORBOARD)

- Furniture - Mahogany Style, Satin Varnish
- Galley cupboard fronts in wood colour
- Floorboard - Acacia

UPHOLSTERY

- Mattresses for all berths
- Upholstery - Monte Carlo, colour: Cream

DECK & OUTSIDE EQUIPMENT

- GRP deck with antislip surface, isophthalic gelcoat, colour: Signal White (RAL 9003), 1st layer vinyl ester resin with balsa sandwich core. 2 cockpit lockers, 1 space for life raft, dinghy garage, stowage for running rigging at helm position and in the steps from the cockpit to side deck, anchor locker at bow.
- Teak on cockpit bottom
- Teak on cockpit benches
- Teak on bathing platform
- Twin wheel steering system with emergency tiller
- 2 stainless steel steering wheels with leather cover
- Cockpit table, stainless steel with teak tops, on stb
- Cockpit table, stainless steel with teak tops, on ps
- Pulpit and pushpit, stainless steel
- Railing, incl. stanchions and stainless steel wire
- Covered halyards and control lines lead to cockpit helmposition, organizers and jammers, 4 mooring cleats, handrails on coach roof
- 2 LEWMAR 50 ST EVO manual halyard winches
- Bathing platform, manual fold-out with swimming ladder
- Composite bowsprit with integrated anchor and forestay fitting, gennaker eye
- Self tacking jib system
- Mainsheet system
- 8 large and 6 small deck hatches - openable, anchor locker hatch
- 4 large coach roof side windows - openable, 4 portlights in coach roof

RIG & SAILS

- Rig, anodized aluminium, deck stepped, with kicker, standing and running rigging and 2 reefs
- Backstay tensioner, manual
- Manual jib furler
- QUANTUM Dacron sails - full battened, main and jib
- Dyneema halyards for main and jib

NAVIGATION & INSTRUMENTS

- Illuminated compass at each helm
- Navigation lights - LED

PROPULSION

- Fuel tank, approx. 200 l
- Engine (Diesel, approx. 80 hp) - saildrive, 3-blade fix propeller

EQUIPMENT

- 12 V and 230 V electric system with main panels and 230 V shore power and sockets in cabins and heads
- Battery set, capacity: 1x 90 Ah + 2x 160 Ah AGM
- Country Version: EU / AUS
- Battery charger 50 A
- Manual toilet with sea water flush - cabin layout B1, B2 or B3
- Manual toilet with sea water flush - cabin layout D1 or D2
- LPG gas system, stowage for 1 gas bottle
- Black water system (appr. 85 l each bathroom) with deck extraction and seacock for head, electric and manual bilge pump
- Fresh water tank, appr. 450 l
- Fresh water system with electric pump and 40 l hot water, heated also by main engine

SHIPPING & TRANSPORT

- CE - Certificate cat. A - 12, B - 14, C - 18
- Owners manual
- EC - Type Examination Certificate